

IMPORTANT: Copyright reserved. This design and drawing is the exclusive property of Cornerstone Architecture and cannot be used for any purpose without the written consent of the Architect. This drawing is not to be used for construction until issued for that purpose by the Architect.

Prior to commencement of the Work, the Contactor shall review and verify drawing dimensions, datums and levels to identify all discrepancies between information on this drawing and 1) actual site conditions; and, 2) the remaining Contract Documents. The Contractor shall bring these items to the attention of the Architect for clarification before proceeding with work.

NOTES:
For Landscaping and paving materials please refer to landscape plans L1-L3.

For more detailed dimensions / height information please refer to floor plans and sections / elevations.

For Survey / Building Grades information please refer to sheet A1.3 (for reference).

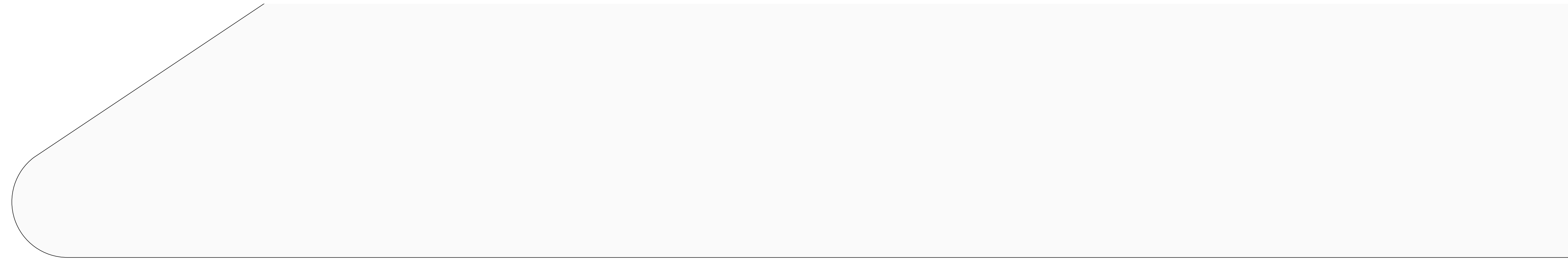
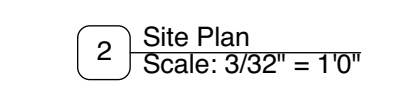
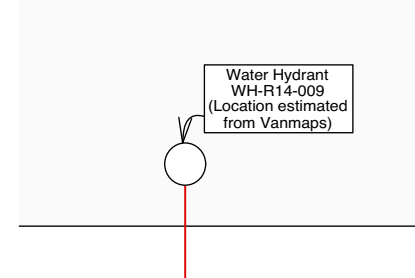
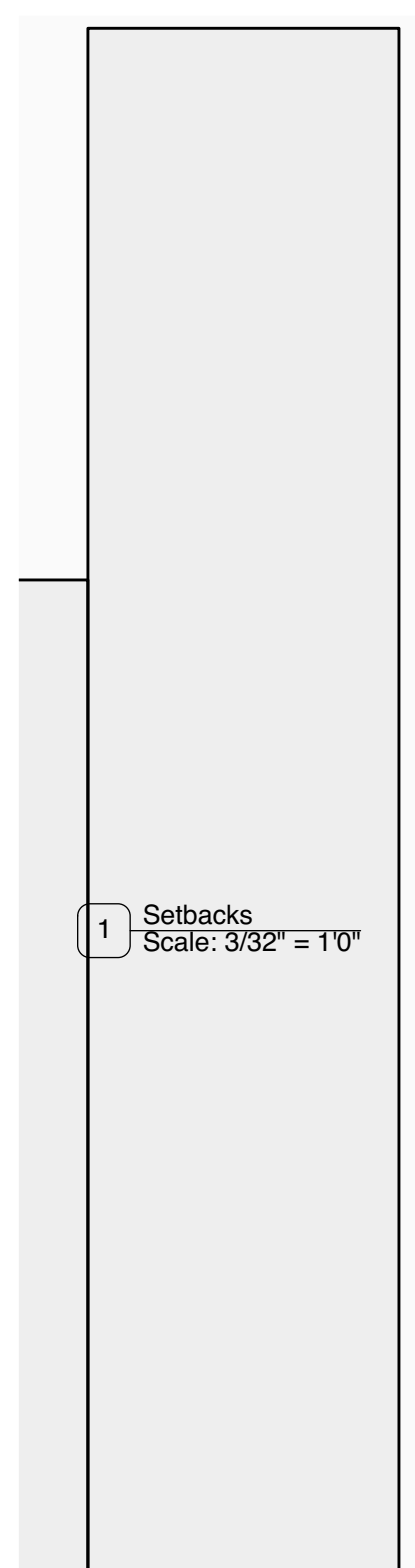
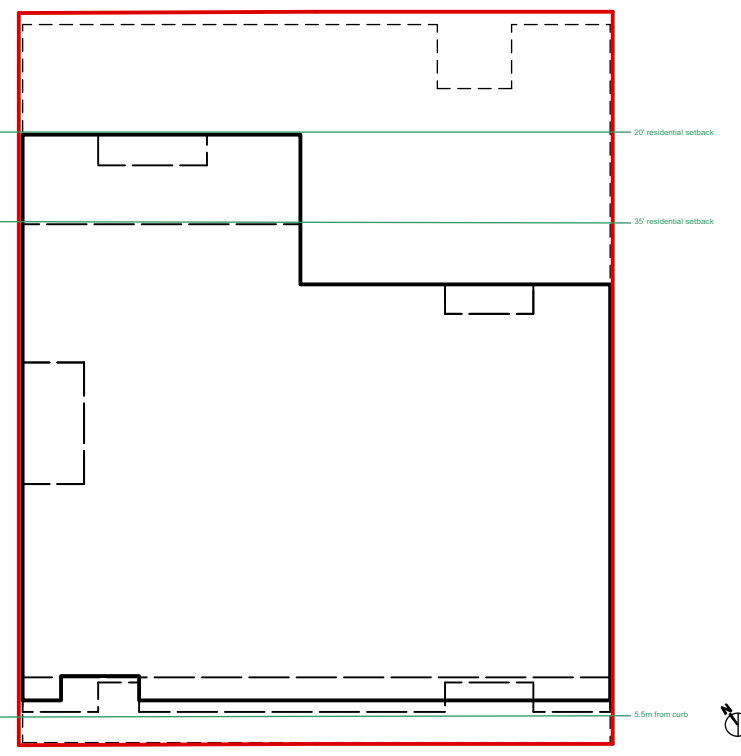

NEIGHBOUR

NEIGHBOUR

KINGSWAY

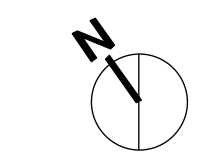

ISSUE / REVISION DATE:

01	Issued For: Rezoning Enquiry	November 24, 2015
02	Issued For: Concurrent Rezoning / DP	December 12, 2016

PERMIT NUMBERS:
Rezoning: RZ - - - - -
Development Permit: DE - - - - -
Building Permit: BU - - - - -

LEGAL:
Survey Plan of Lots 13 and 14 both of Block 90, District Lot 301, New Westminster District, Plan 187

SEAL (IF REQ'D):

PROJECT:

855 Kingsway
855 Kingsway, Vancouver B.C.
Mixed-Use Residential/Retail Development

BUILDING CODE: VBBL 2014 ZONING: Rezoning from Zone C2

DRAWING TITLE:

Site Plan

PLOT/ISSUE DATE:	REVIEWED:	DRAWN:
Jan. 23, 2016	SK	GZ

PROJECT NO.: 1525 SCALE (U.N.O.): 1/8" = 1'0"

REVISION: 02 DRAWING NO.: A1.4