

MATTHEW CHENG ARCHITECT INC.

Unit 202 - 670 EVANS AVENUE
VANCOUVER, BC V6A 2K9
Tel: (604) 731-3017 / Fax: (604) 731-3908
Cel: (604) 649-0669 / Email: matthew@mcai.ca

THIS DRAWING MUST NOT BE SCALED. THE GENERAL CONTRACTOR SHALL VERIFY ALL DIMENSIONS AND LEVELS PRIOR TO COMMENCEMENT OF WORK. ALL ERRORS AND OMISSIONS SHALL BE REPORTED IMMEDIATELY TO THE ARCHITECT. COPYRIGHT RESERVED. THIS PLAN AND DESIGN ARE AND AT ALL TIMES REMAIN THE EXCLUSIVE PROPERTY OF MATTHEW CHENG ARCHITECT INC. AND MAY NOT BE USED OR REPRODUCED WITHOUT PRIOR WRITTEN CONSENT.

| No. | Date | Revision |
|-----|------------|---------------------|
| 01 | 2014/08/21 | Issued for Rezoning |

Legend/Drawing Notes

Project Title
5658 VICTORIA DRIVE VANCOUVER, BC

Sheet Title
P2 PARKING PLAN

Drawn:
GRW

Checked:
MC

Scale:
1/16"=1'-0"

Revision Date:
August 21, 2014

Print Date:
August 21, 2014

Dwg. No.
A03

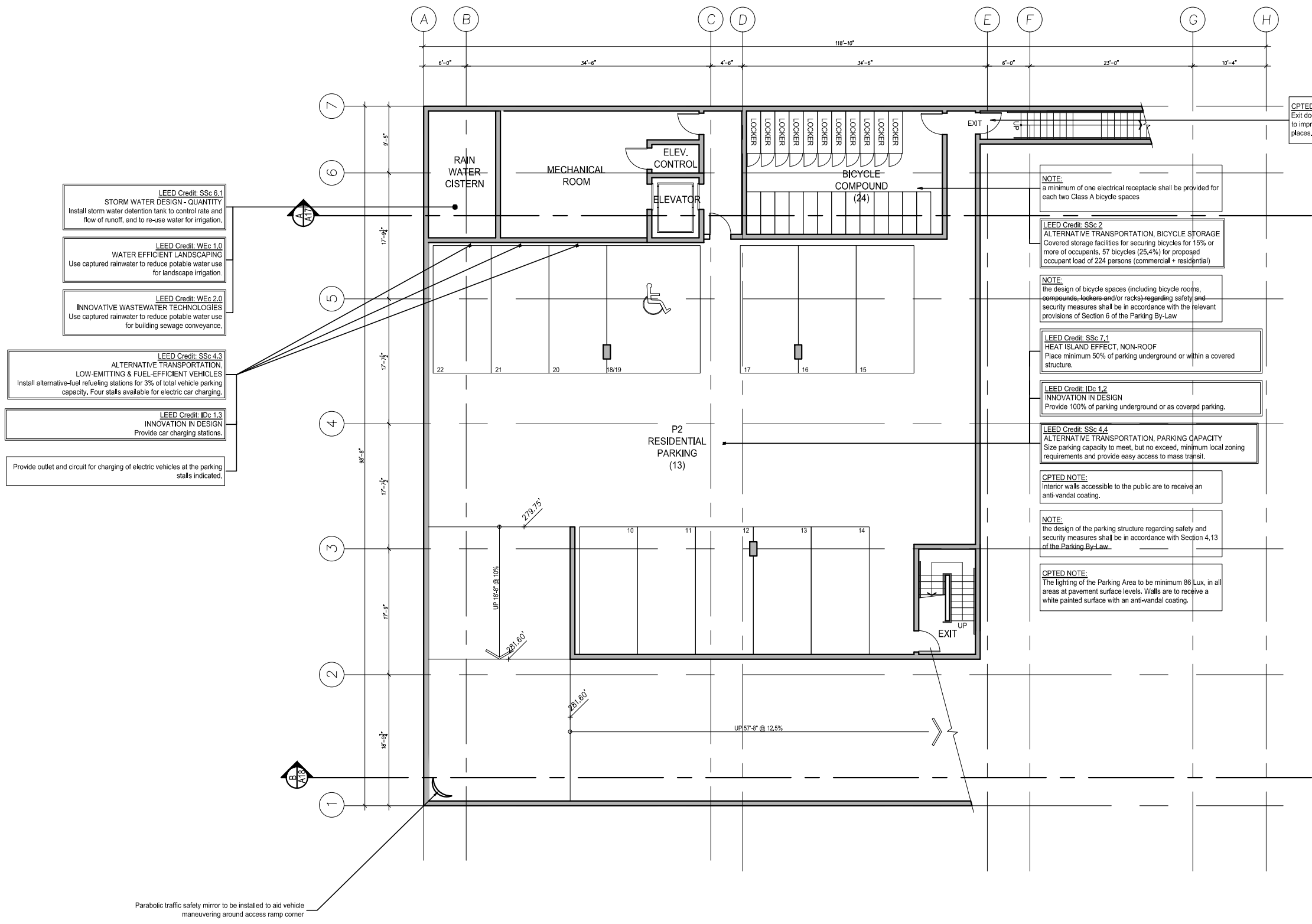

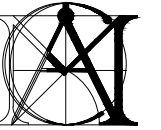

MATTHEW CHENG ARCHITECT INC.

Unit 202 - 670 EVANS AVENUE
VANCOUVER, BC V6A 2K9
Tel: (604) 731-3017 / Fax: (604) 731-3908
Cel: (604) 649-0669 / Email: matthew@mcai.ca

THIS DRAWING MUST NOT BE SCALED. THE GENERAL CONTRACTOR SHALL VERIFY ALL DIMENSIONS AND LEVELS PRIOR TO COMMENCEMENT OF WORK. ALL ERRORS AND OMISSIONS SHALL BE REPORTED IMMEDIATELY TO THE ARCHITECT. COPYRIGHT RESERVED. THIS PLAN AND DESIGN ARE AND AT ALL TIMES REMAIN THE EXCLUSIVE PROPERTY OF MATTHEW CHENG ARCHITECT INC. AND MAY NOT BE USED OR REPRODUCED WITHOUT PRIOR WRITTEN CONSENT.

| No. | Date | Revision |
|-----|------------|---------------------|
| 01 | 2014/08/21 | Issued for Rezoning |

Legend/Drawing Notes

Project Title
**5658 VICTORIA DRIVE
VANCOUVER, BC**

Sheet Title
P1 PARKING PLAN

Drawn:
GRW

Checked:
MC

Scale:
1/16"=1'-0"

Revision Date:
August 21, 2014

Print Date:
August 21, 2014

Dwg. No.
A04

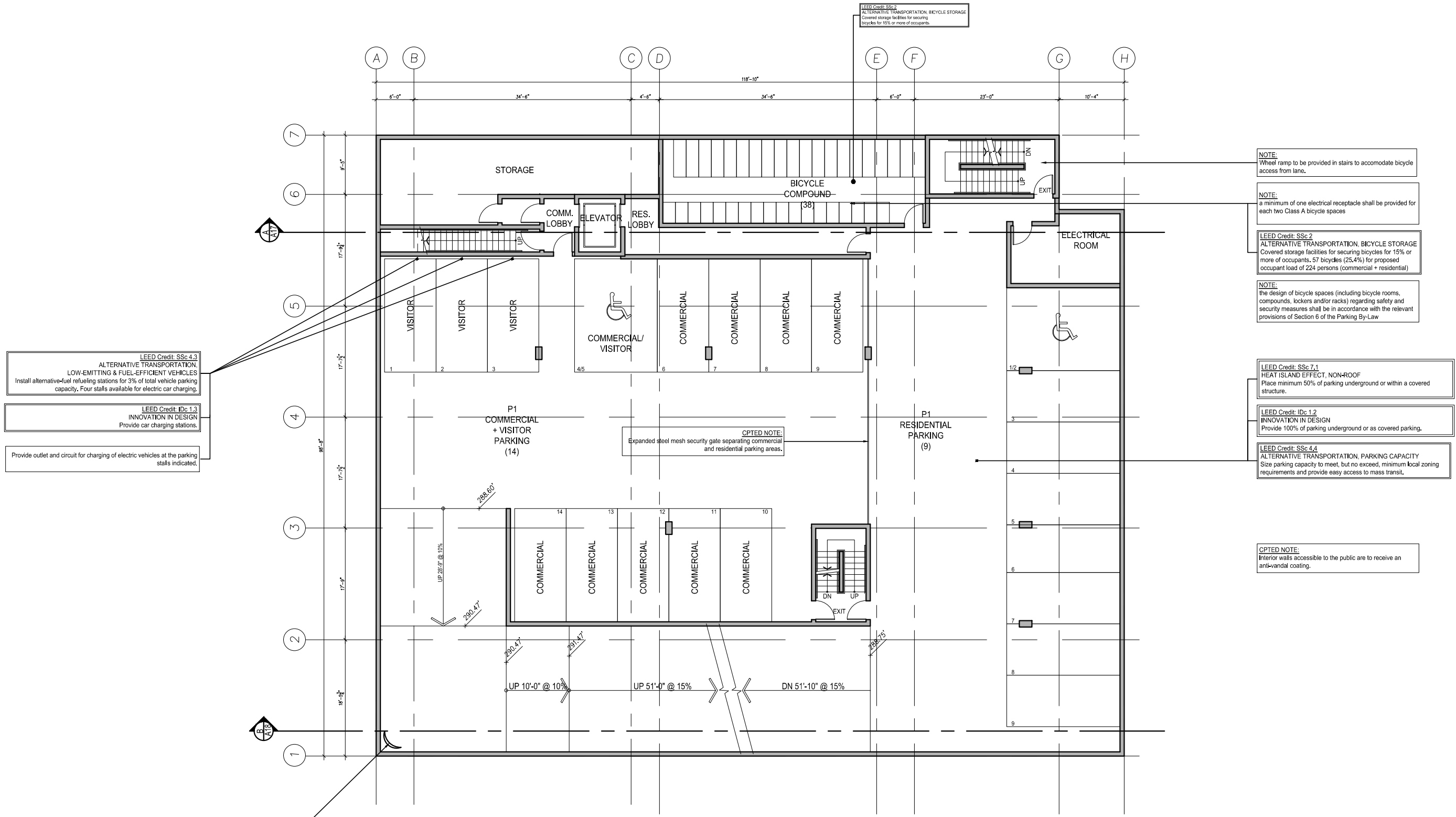

Parabolic traffic safety mirror to be installed to aid vehicle maneuvering around access ramp corner

NOTE:
Wheel ramp to be provided in stairs to accommodate bicycle access from lane.

NOTE:
a minimum of one electrical receptacle shall be provided for each two Class A bicycle spaces

LEED Credit: SSc 2
ALTERNATIVE TRANSPORTATION, BICYCLE STORAGE
Covered storage facilities for securing bicycles for 15% or more of occupants, 57 bicycles (25.4%) for proposed occupant load of 224 persons (commercial + residential)

NOTE:
the design of bicycle spaces (including bicycle rooms, compounds, lockers and/or racks) regarding safety and security measures shall be in accordance with the relevant provisions of Section 6 of the Parking By-Law

LEED Credit: SSc 7.1
HEAT ISLAND EFFECT, NON-ROOF
Place minimum 50% of parking underground or within a covered structure.

LEED Credit: IdC 1.2
INNOVATION IN DESIGN
Provide 100% of parking underground or as covered parking.

LEED Credit: SSc 4.4
ALTERNATIVE TRANSPORTATION, PARKING CAPACITY
Size parking capacity to meet, but no exceed, minimum local zoning requirements and provide easy access to mass transit.

CPTED NOTE:
Interior walls accessible to the public are to receive an anti-vandal coating.