

Copyright reserved. This design and drawings are the exclusive property of the architect and cannot be used for any purpose without the written consent of the designer.
 This drawing is not to be used for construction until issued for that purpose by the designer.
 Prior to commencement of the Work the Contractor shall verify all dimensions, datums and levels to identify any errors and omissions, ascertain any discrepancies between this drawing and the full Contract Document, and bring these items to the attention of the owner for clarification.

HOTSON

HOTSON architecture
 210 WEST HASTING STREET
 VANCOUVER, BC V6B 1G8
 CANADA
 604 376 3692
 info@hotson.ca

Revisions and Issues:

Rev	Description	DATE
1	Rezoning Submission	16/12/21



June 21st - 10am

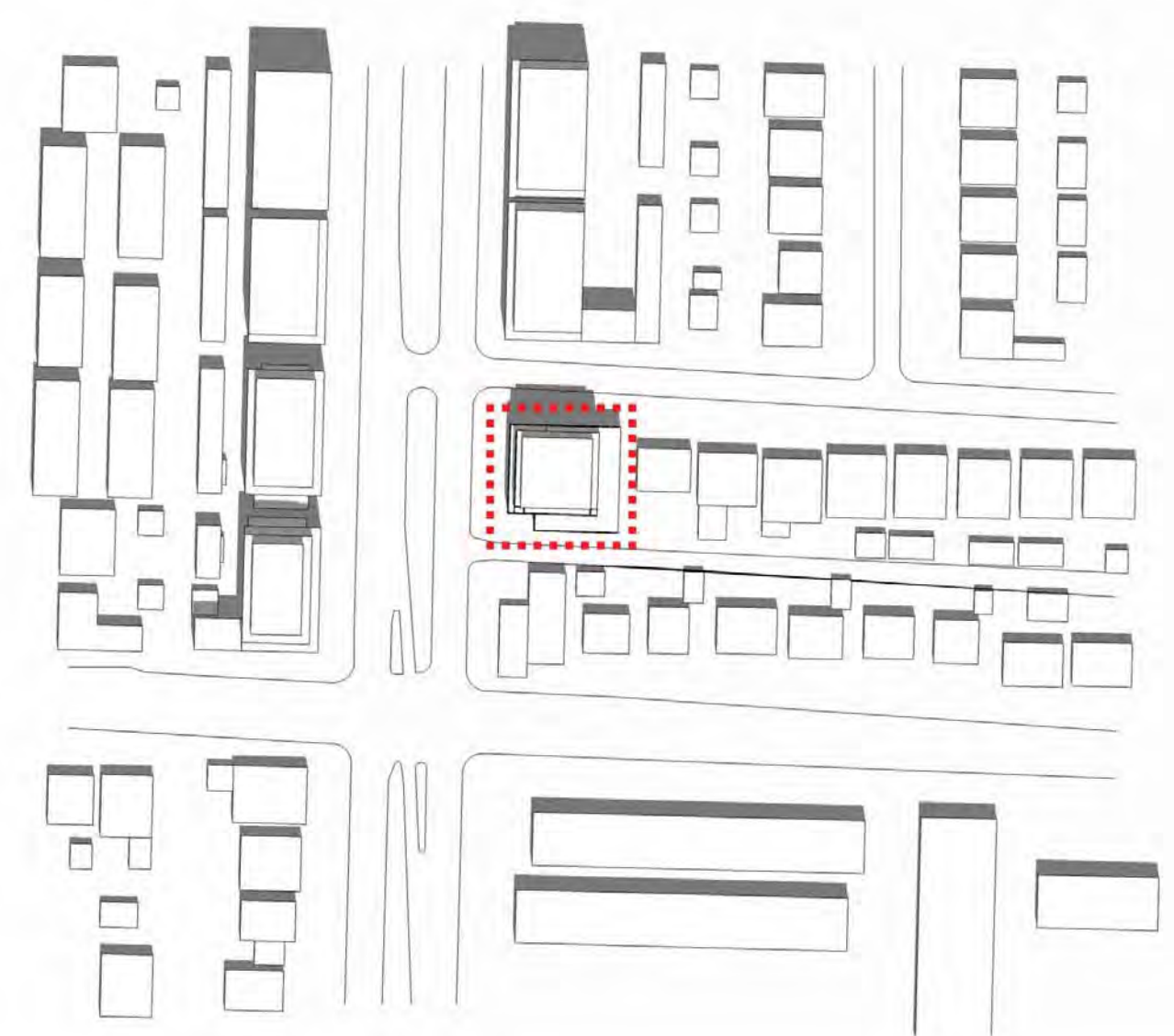

June 21st - 12pm

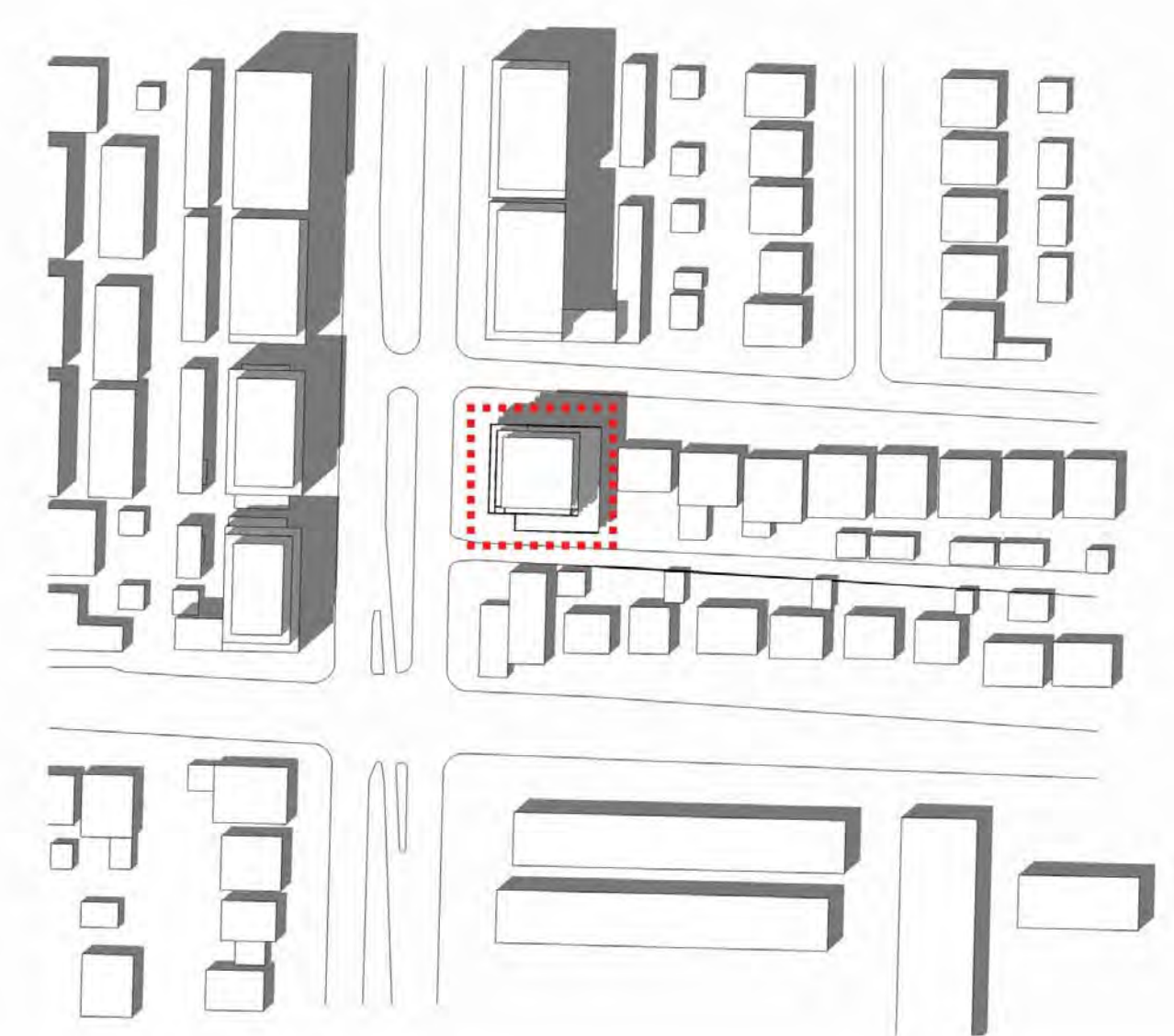

June 21st - 2pm

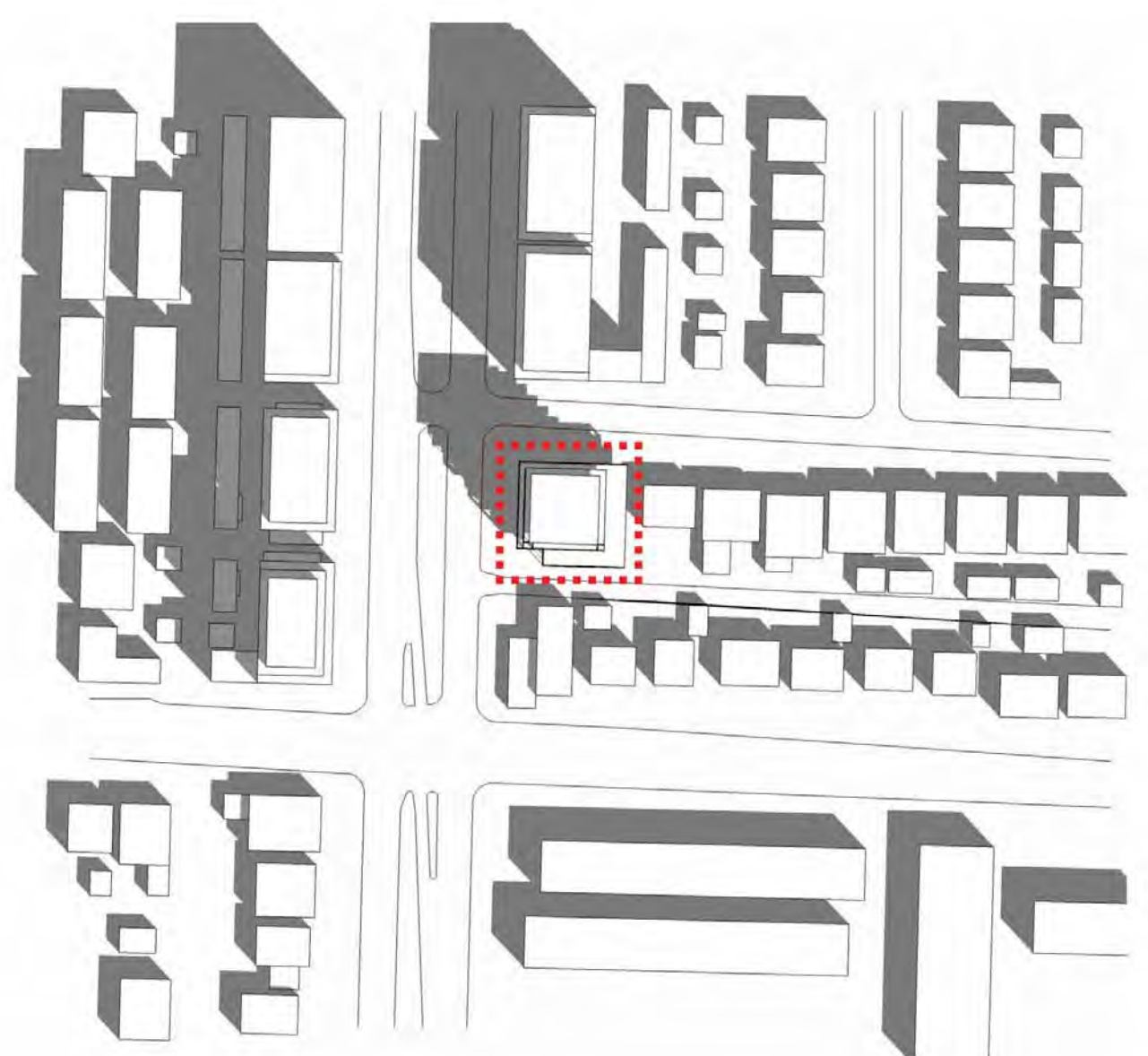

March 21st - 10am

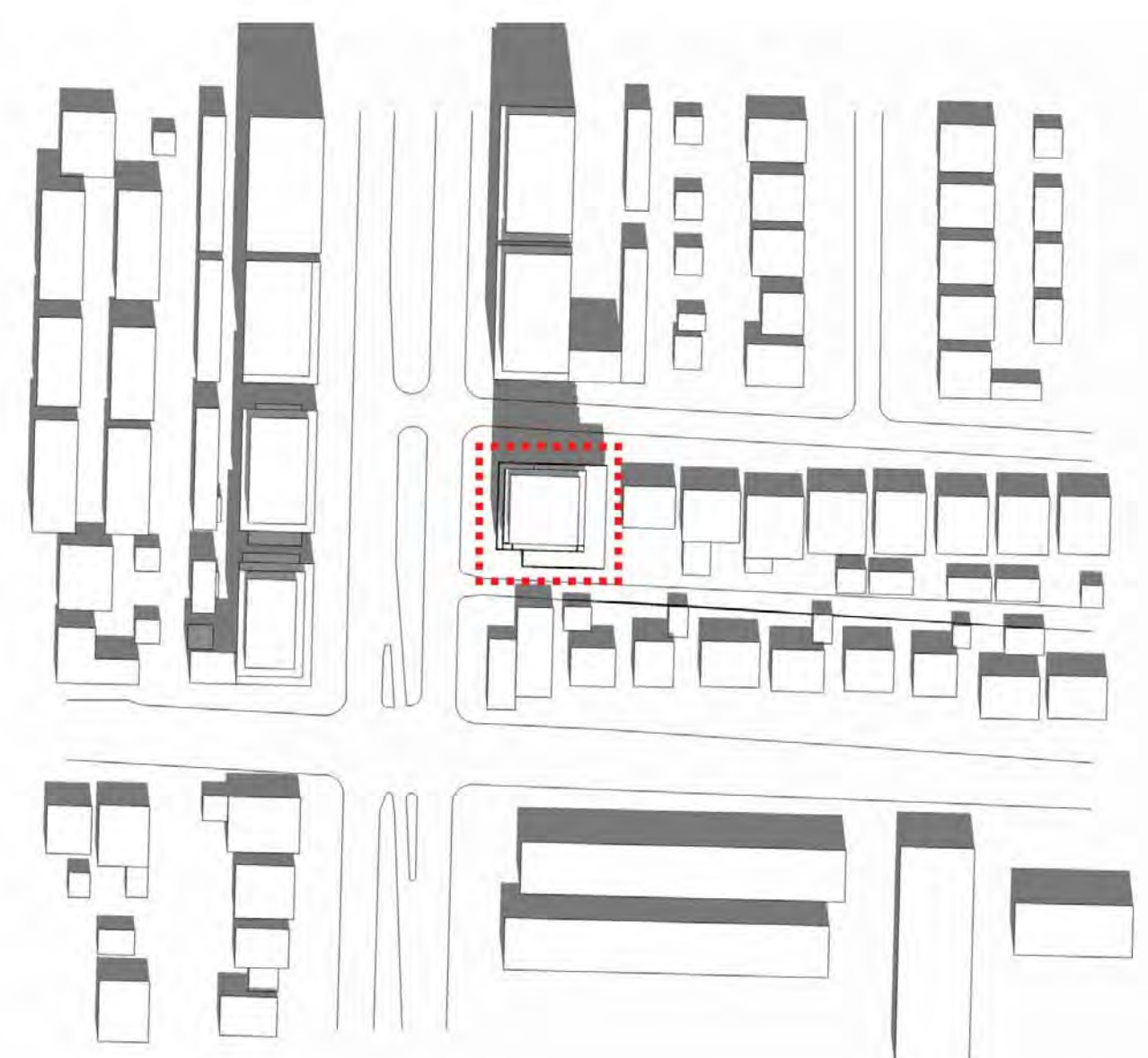

March 21st - 12pm

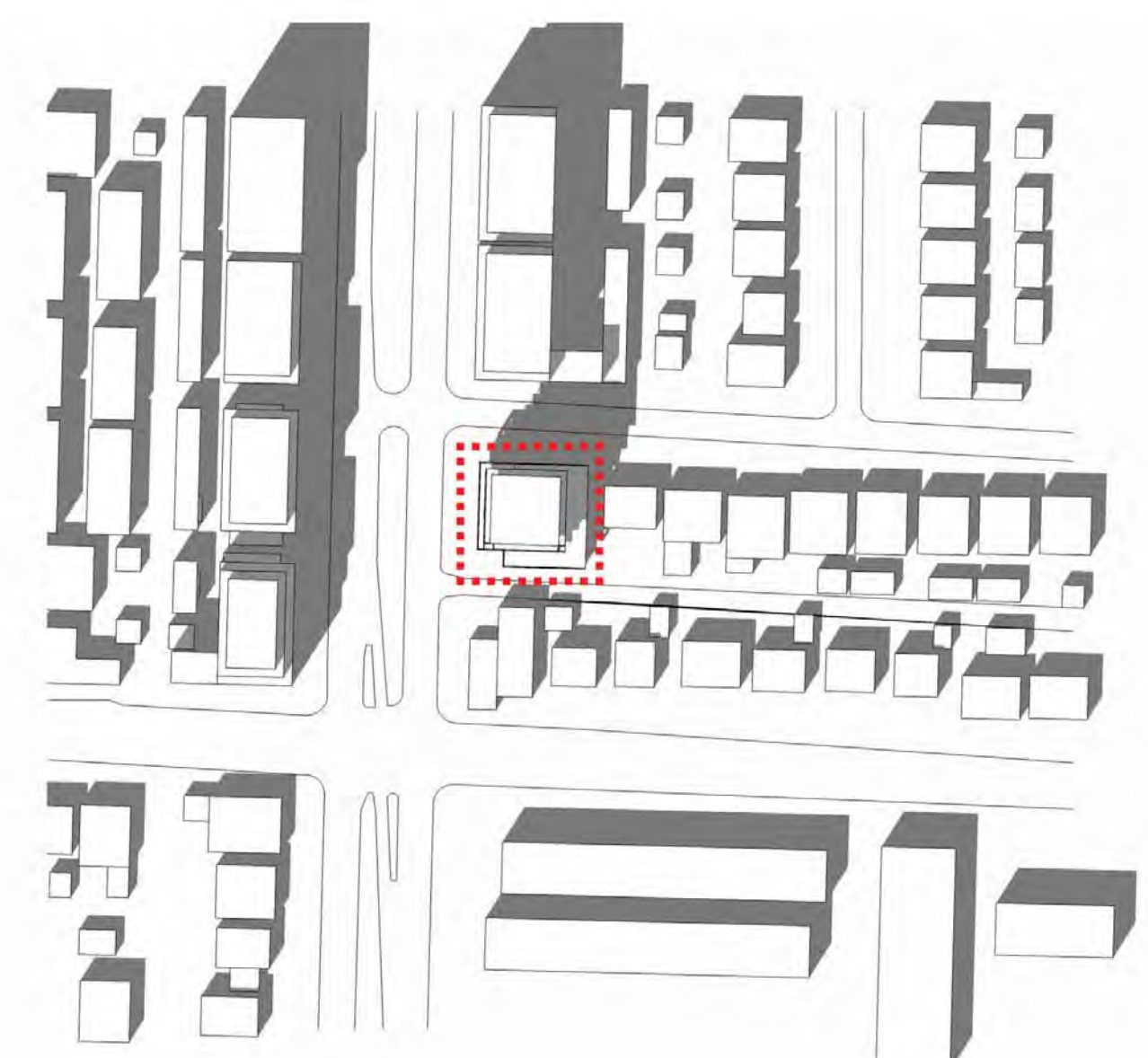

March 21st - 2pm

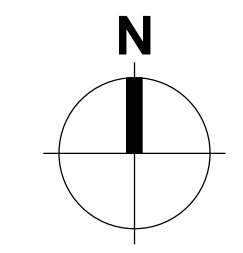

Client -

Address -

Project 48th and Cambie

Address 478-496 W 48th Ave
 Vancouver, BC

DRAWING TITLE: Shadow Studies

Scale:

DATE: 12/04/16

PROJECT #: 1502

DRAWING NUMBER: **A005**