

UPPER LEVEL FLOOR AREA
EXISTING FLOOR AREA 1,004.6 SQ.M. (10,813 SQ.FT.)
PROPOSED ADDITIONAL FLOOR AREA 112.1 SQ.M. (1,206 SQ.FT.)
TOTAL PROPOSED FLOOR AREA 1,116.7 SQ.M. (12,019 SQ.FT.)

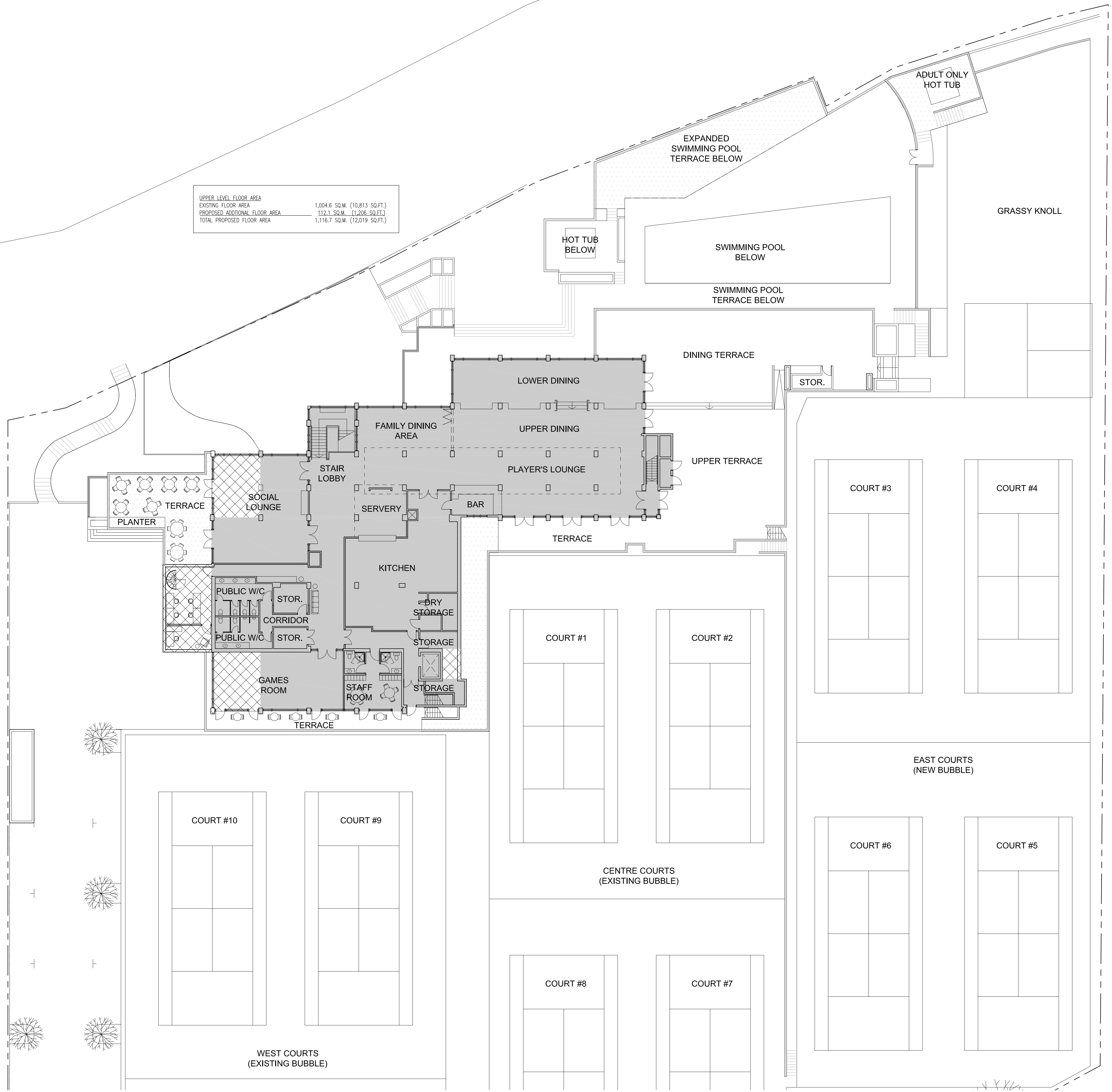

ALL OF THE DOCUMENTS PREPARED BY PROSCENIUM ARCHITECTURE + INTERIORS INC. OR ON BEHALF OF PROSCENIUM ARCHITECTURE + INTERIORS INC. IN CONNECTION WITH THE PROJECT ARE INSTRUMENTS OF SERVICE FOR THE EXECUTION OF THE PROJECT. PROSCENIUM ARCHITECTURE + INTERIORS INC. RETAINS THE PROPERTY AND COPYRIGHT IN THESE DOCUMENTS, WHETHER THE PROJECT IS EXECUTED OR NOT. THESE DOCUMENTS MAY NOT BE USED ON ANY OTHER PROJECT WITHOUT PRIOR WRITTEN AGREEMENT OF PROSCENIUM ARCHITECTURE + INTERIORS INC. DO NOT SCALE DRAWINGS.

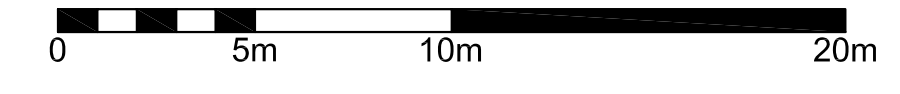

LEGEND
EXISTING FLOOR AREA [Solid Grey Box]
NEW FLOOR AREA [Cross-hatched Box]
NEW EXTERIOR AREA [Dotted Box]

REV.	DESCRIPTIONS	BY	DATE
-	ISSUED FOR REZONING APPLICATION	KC	11.06.01
CAD FILE: 1008X200		REVISION NO. []	

PROJECT
JERICHO TENNIS CLUB
REZONING

PROJECT NUMBER
10-08

DWG. NO.
A202

DRAWING TITLE
PROPOSED PARTIAL
UPPER FLOOR
PLAN

DATE
JUNE 2011

SCALE
1/16" = 1'-0"

DRAWN
GP

CHECKED
KC