

**NOT FOR
CONSTRUCTION**

Issue

- 01. SEP 13 2019 - ISSUE FOR COORDINATION
- 02. OCT 11 2019 - ISSUE FOR REVIEW
- 03. OCT 18 2019 - ISSUE FOR REVIEW
- 04. OCT 22 2019 - ISSUE FOR CITY REVIEW
- 05. OCT 29 2019 - PRE-REZONING APPLICATION REVIEW
- 06. NOV 08 2019 - REZONING APPLICATION
- 07. NOV 08 2019 - DESIGN DEVELOPMENT
- 08. JAN 21 2020 - DESIGN DEVELOPMENT
- 09. FEB 20 2020 - DESIGN DEVELOPMENT
- 10. FEB 26 2020 - DESIGN DEVELOPMENT
- 11. MAR 09 2020 - DESIGN DEVELOPMENT
- 12. APR 17 2020 - REZONING RESUBMISSION COV REVIEW
- 13. MAY 08 2020 - REZONING RESUBMISSION
- 14. MAY 12 2020 - REZONING RESUBMISSION
- 15. MAY 21 2020 - REZONING RESUBMISSION

Revision

Revision	Description

All drawings and related documents are the property of Leckie Studio Architecture + Design Inc. and may not be reproduced in whole or in part without the architect's permission. This drawing should not be used to calculate areas. Do not scale this drawing. All dimensions to be confirmed on site by the general contractor and such dimensions to be their responsibility. All work must comply with the relevant Building Code By Law and related documents. Drawing errors and omissions must be immediately reported to the architect.

Client

**Westbank
Broadway +
Alma**

3743, 3701 West Broadway

Drawing Title

**Massing Setbacks
Plan**

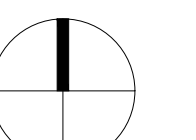

Drawn / Checked: LSAD Project Code: WBA

Scale: 1:100 @ 22 x 34 Date: 1:200 @ 11 x 17

Sheet Number: Revision:

A312

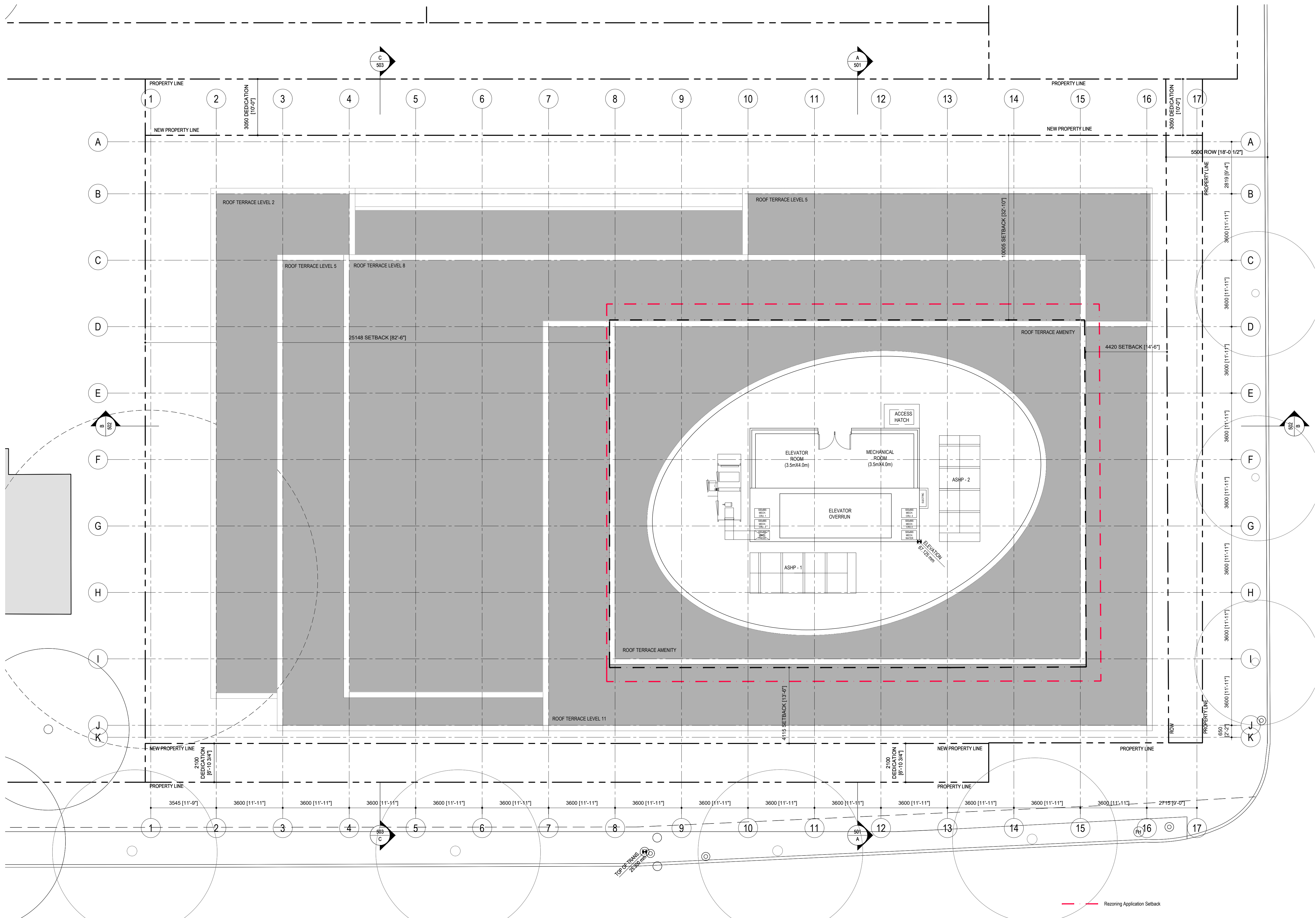

--- Rezoning Application Setback