

IMPORTANT: Copyright reserved. This design and drawing is the exclusive property of Cornerstone Architecture and cannot be used for any purpose without the written consent of the Architect. This drawing is not to be used for construction until issued for that purpose by the Architect.

Prior to commencement of the Work, the Contractor shall review and verify drawing dimensions, datums and levels to identify all discrepancies between information on this drawing and 1) actual site conditions; and 2) the remaining Contract Documents. The Contractor shall bring these items to the attention of the Architect for clarification before proceeding with work.

CONTACT INFORMATION:

Architectural
cornerstone architecture
vancouver, canada

408 - 611 Alexander Street
Vancouver, British Columbia
Canada, V6A 1E1
www.cornerarch.com
tel: 604 253-8800
fax: 604 253-8133

CONTACT INFORMATION:

ARCHITECTURAL
cornerstone architecture

Contact: Mr. Scott
Kennedy
Contact: Mr. Andres
Vargas
408 - 611 Alexander Street
Vancouver B.C. V6A 1E1
www.cornerarch.com
tel: 604 253-8800
fax: 604 253-8133

PROJECT:

3501-3523 E HASTINGS
MIXED-USE RESIDENTIAL /
COMMERCIAL DEVELOPMENT
VANCOUVER B.C.

ADDRESS:

3501-3523 E HASTINGS
VANCOUVER B.C.

DRAWING:

SITE PLAN

ISSUE / REVISION DATE:

Issued For Review Jan 15, 2014

DRAWN

REVIEWED

SCALE 1:100 (unless noted otherwise)
(units in meters)

PLOT DATE January 15, 2014

PROJECT NO.

1307

DRAWING NO.

A1.1

REVISION

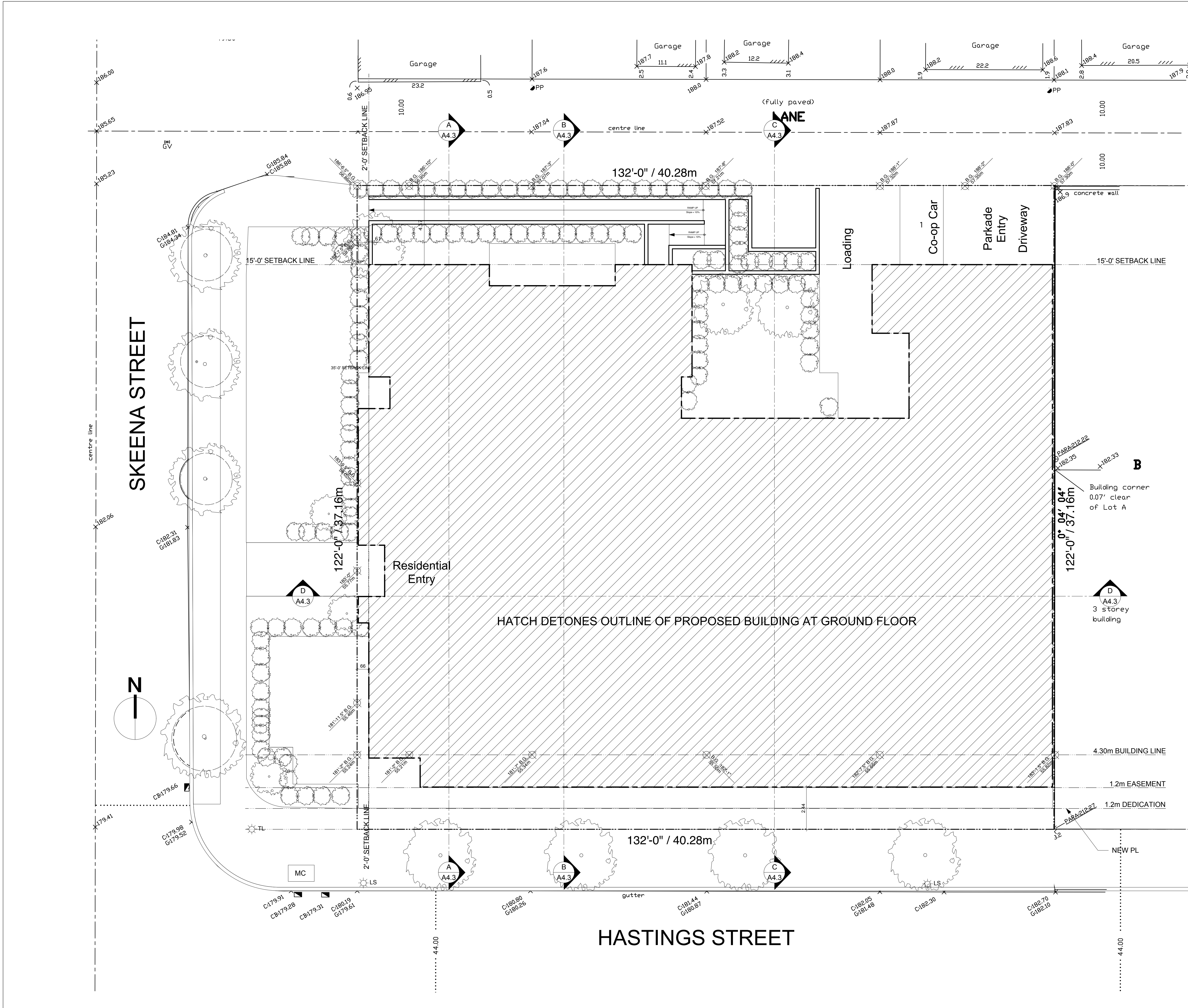

SKEENA STREET

HASTINGS STREET

HATCH DETONES OUTLINE OF PROPOSED BUILDING AT GROUND FLOOR

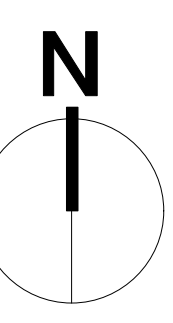

MC

LS

gutter

NEW PL

4.30m BUILDING LINE

1.2m EASEMENT

1.2m DEDICATION

Building corner
0.07' clear
of Lot A

concrete wall

(fully paved)
LANE

2'-0" SETBACK LINE

2'-0" SETBACK LINE

15'-0" SETBACK LINE

15'-0" SETBACK LINE

132'-0" / 40.28m

132'-0" / 40.28m

122'-0" / 37.16m

122'-0" / 37.16m

Residential
Entry

Loading

Co-op Car

Parkade
Entry

Driveway

G185.84
C185.98

G184.81
G184.34

C182.31
G181.63

C8179.66

C179.98
G179.52

C8179.91

C8179.28

C8179.91

C180.19
G179.61

C180.80
G180.26

C181.44
G180.87

C182.05
G181.48

C182.30

C182.70
G182.10

X186.00

X185.65

X185.23

X182.06

X179.41

0.6 X

X186.95

X185.84

X185.98

X185.84

X185.98

X185.84

X185.98

X182.06

X182.33

X182.35

X182.35

X182.35

X182.35

X182.35

X182.35

X187.04

X187.04

X187.04

X187.04

X187.04

X187.04

X187.04

X187.04

X187.04

X187.04

X187.04

X187.04

X187.04

X187.04

X187.04

X187.04

X187.04

X187.04

X187.04

X187.04

X187.04

X187.04

X187.04

X187.04

X187.04

X187.04

X187.04

X187.04

X187.7

X187.7

X187.8

X187.8

X188.2

X188.2

X188.2

X188.2

X188.2

X188.2

X188.2

X188.2

X188.2

X188.2

X188.2

X188.2

X188.2

X188.2

X188.2

X188.2

X188.2

X188.2

X188.2

X188.2

X188.2

X188.2

X188.2

X188.2

X188.2

X188.2

X188.0

X188.0

X188.2

X188.2

X188.2

X188.2

X188.2

X188.2

X188.2

X188.2

X188.2

X188.2

X188.2

X188.2

X188.2

X188.2

X188.2

X188.2

X188.2

X188.2

X188.2

X188.2

X188.2

X188.2

X188.2

X188.2

X188.2

X188.2

X187.87

X187.87

X187.87

X187.87

X187.87

X187.87

X187.87

X187.87

X187.87

X187.87

X187.87

X187.87

X187.87

X187.87

X187.87

X187.87

X187.87

X187.87

X187.87

X187.87

X187.87

X187.87

X187.87

X187.87

X187.87

X187.87

X187.87

X187.87

X187.83

X187.83

X187.83

X187.83

X187.83

X187.83

X187.83

X187.83

X187.83

X187.83

X187.83

X187.83

X187.83

X187.83

X187.83

X187.83

X187.83

X187.83

X187.83

X187.83

X187.83

X187.83

X187.83

X187.83

X187.83

X187.83

X187.83

X187.83

X187.83

X187.83

0.5

0.5

0.5

0.5

0.5

0.5

0.5

0.5

0.5

0.5

0.5

0.5

0.5

0.5

0.5

0.5

0.5

0.5

0.5

0.5

0.5

0.5

0.5

0.5

0.5

0.5

0.5

0.5

0.5

0.5

0.6

0.6

0.6

0.6

0.6

0.6

0.6

0.6

0.6

0.6

0.6

0.6

0.6

0.6