

**Issues**

9 Jun 10 Issued for UDP Workshop  
26 Jul 10 Issued for Rezoning

**revisions**

2 Jun 11 Revised Rezoning Submission  
6 Oct 11 Revised Rezoning Submission

**GENERAL NOTES:**

- 20% of parking stalls to accommodate electric vehicles.
- Parking for Cultural and Recreation Uses (artist's production space), Service Uses (restaurant), and Retail Uses collectively labelled 'commercial'.

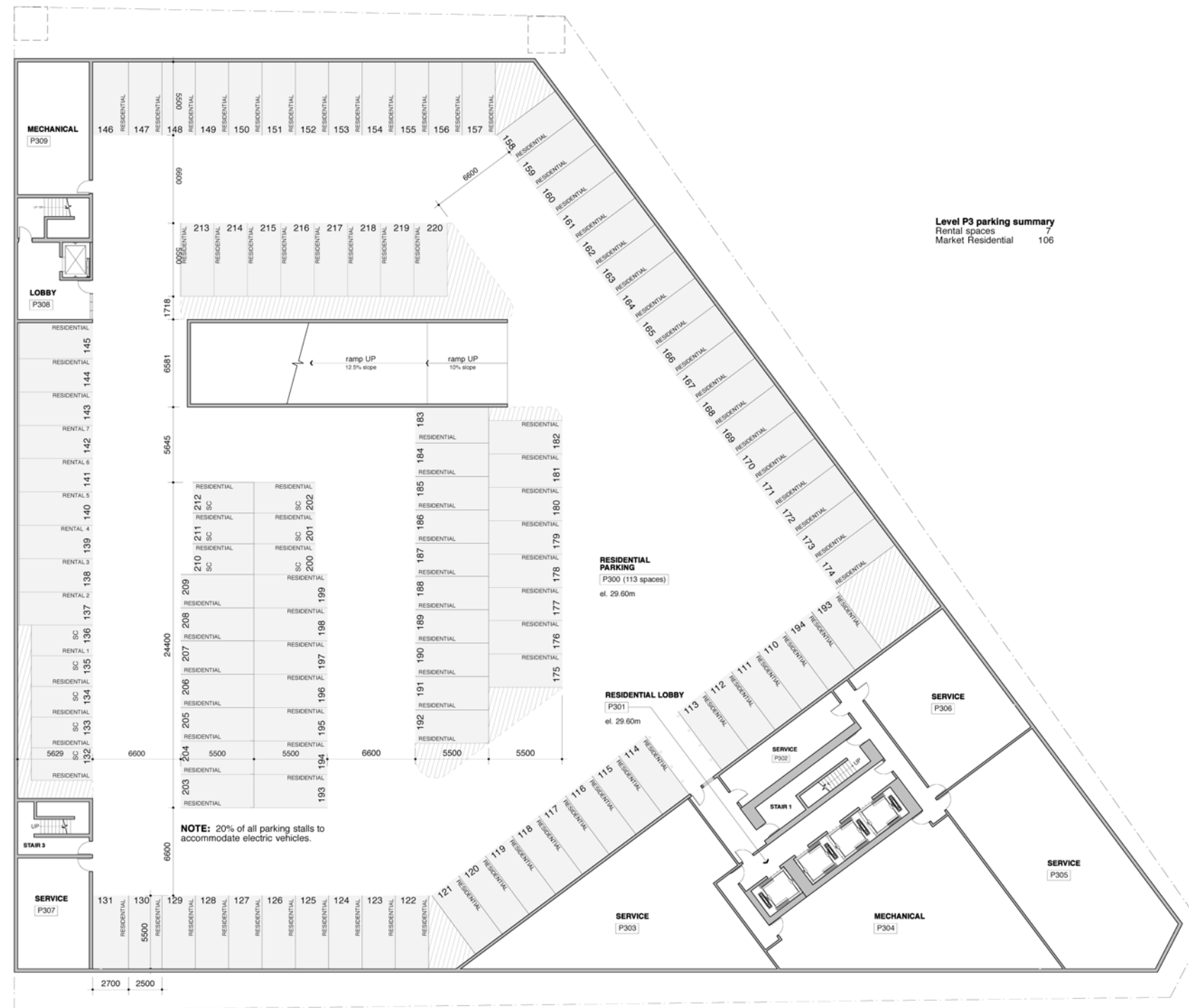

**ACTON OSTRY ARCHITECTS INC**

111 E 8 Avenue  
Vancouver BC  
Canada V5T 1R8  
t 604.739.3344  
f 604.739.3355  
info@actonostroy.ca

**Kingsway + Broadway**

Rize Alliance  
Kingsway + Broadway

scale	date
1 : 200	6 Oct 11
project code	status
KWY	Rezoning
drawn	checked
WS	RA



**Parking Level 3**

drawing number  
**A1.01**

**issues**

9 Jun 10 Issued for UDP Workshop  
26 Jul 10 Issued for Rezoning

**revisions**

2 Jun 11 Revised Rezoning Submission  
6 Oct 11 Revised Rezoning Submission

**GENERAL NOTES:**

- 20% of parking stalls to accommodate electric vehicles.
- Parking for Cultural and Recreation Uses (artist's production space), Service Uses (restaurant), and Retail Uses collectively labelled 'commercial'.

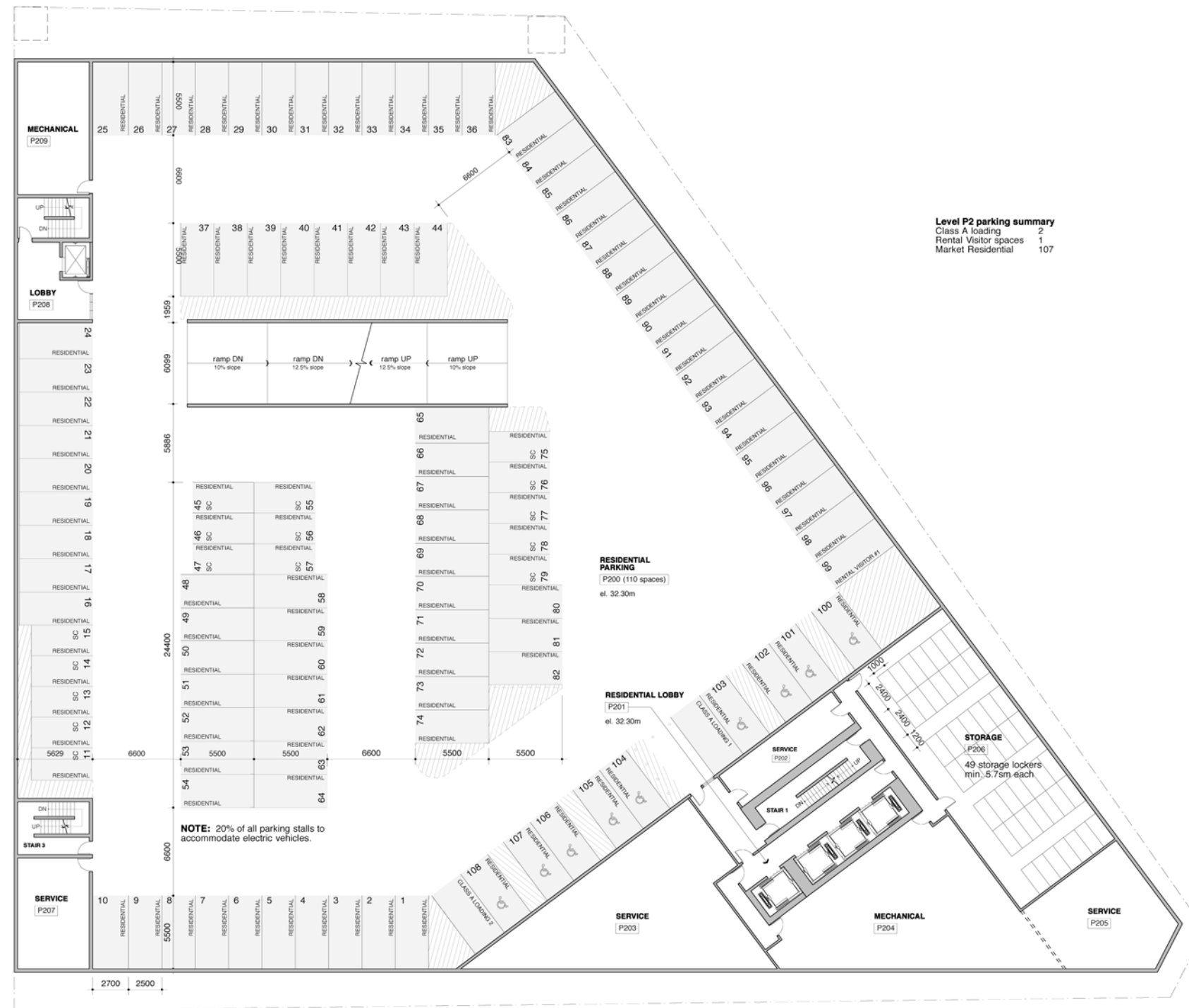

**Level P2 parking summary**  
Class A loading 2  
Rental Visitor spaces 1  
Market Residential 107

**NOTE:** 20% of all parking stalls to accommodate electric vehicles.

**ACTON OSTRY ARCHITECTS INC**

111 E 8 Avenue  
Vancouver BC  
Canada V5T 1R8  
t 604.739.3344  
f 604.739.3355  
info@actonostry.ca

**Kingsway + Broadway**

Rize Alliance  
Kingsway + Broadway

scale	date
1: 200	6 Oct 11
project code	status
KWY	Rezoning
drawn	checked
WS	RA



**Parking Level 2**

drawing number  
**A1.02**

**Issues**

9 Jun 10 Issued for UDP Workshop  
26 Jul 10 Issued for Rezoning

**revisions**

2 Jun 11 Revised Rezoning Submission  
6 Oct 11 Revised Rezoning Submission

**GENERAL NOTES:**

- 20% of parking stalls to accommodate electric vehicles.
- Parking for Cultural and Recreation Uses (artist's production space), Service Uses (restaurant), and Retail Uses collectively labelled 'commercial'.

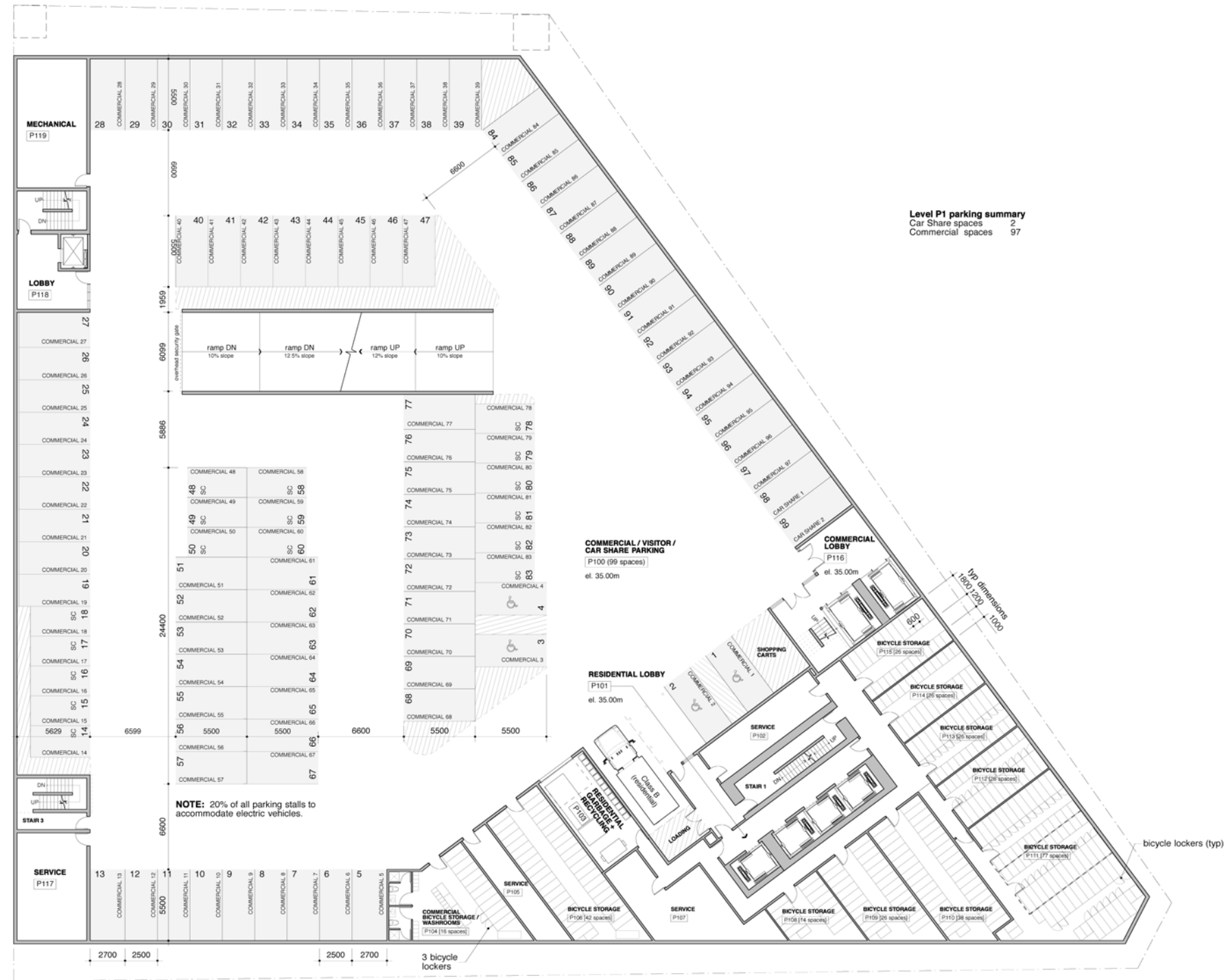

**Level P1 parking summary**  
Car Share spaces 2  
Commercial spaces 97

**ACTON OSTRY ARCHITECTS INC**

111 E 8 Avenue  
Vancouver BC  
Canada V5T 1R8  
t 604.739.3344  
f 604.739.3355  
info@actonostroy.ca

**Kingsway + Broadway**

Rize Alliance  
Kingsway + Broadway

scale	date
1 : 200	6 Oct 11
project code	status
KWY	Rezoning
drawn	checked
WS	RA



**Parking Level 1**

drawing number  
**A1.03**