

Shadow Impacts: Summer Solstice (PST)

- There are no shadows cast on public areas of Emery Barnes Park by the proposed development.
- There are no additional shadow impacts on the Granville Street entertainment district in the morning by the proposed development at 155' height.
- As indicated in the diagrams on this page, there are very minor additional shadows cast by the proposed building height on the Helmcken Street between 12 pm – 1.30 pm. The shadowing increases on the NW corner of Helmcken and Seymour infilling between existing building shadows between 3-4 pm.

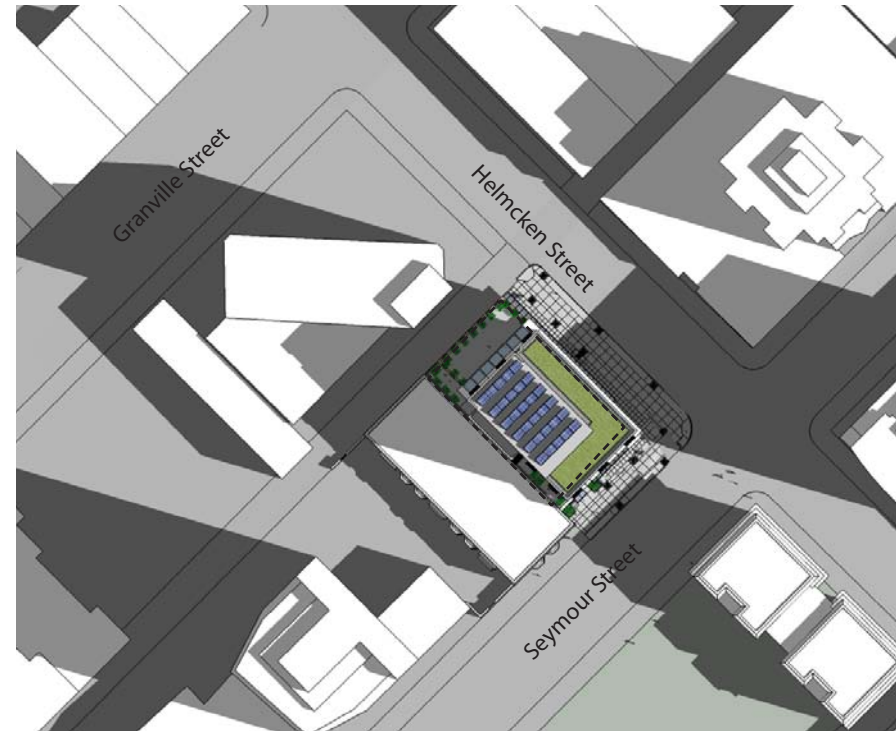

1) Summer Solstice 9:00am PST

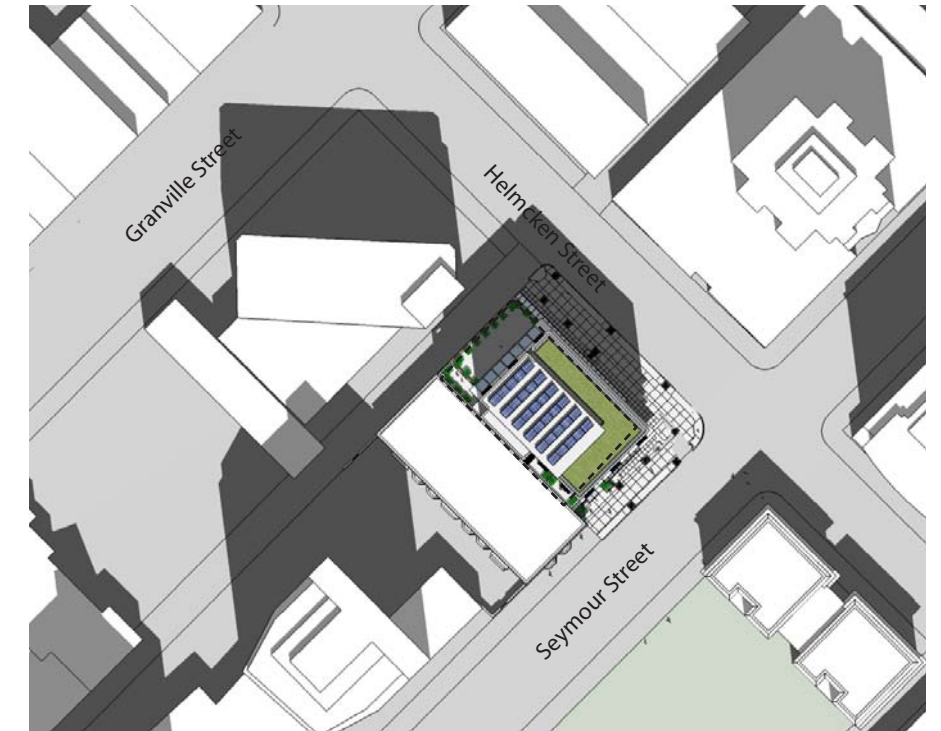

2) Summer Solstice 12:00pm PST



3) Summer Solstice 3:00pm PST

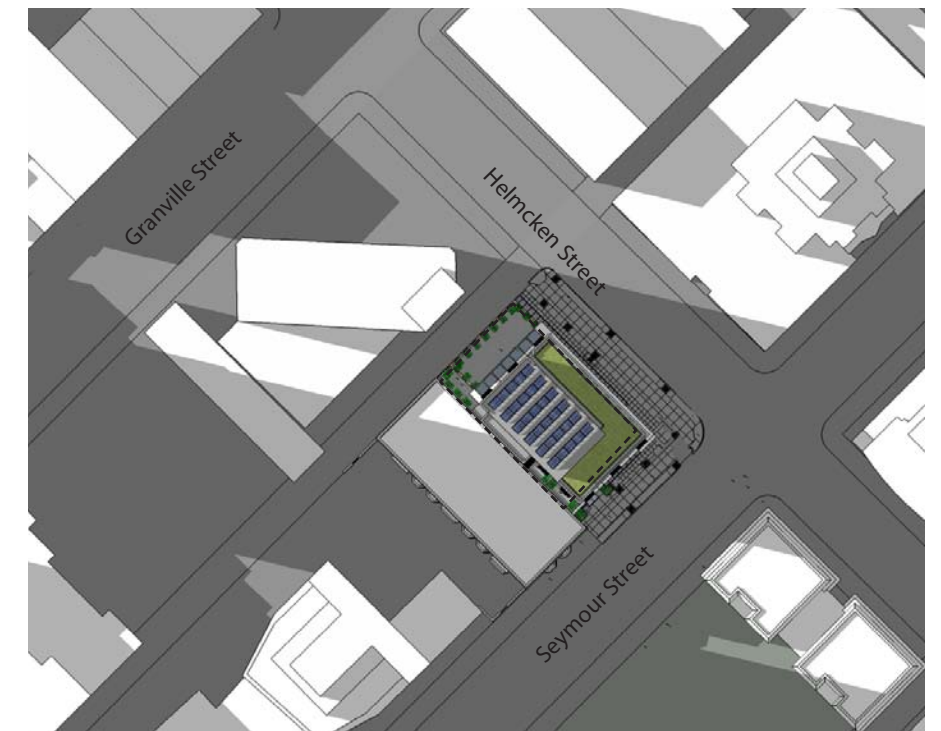

4) Summer Solstice 6:00pm PST



Shadow Impacts: Equinox (PST)

- There are no shadows cast on the public areas of Emery Barnes Park by the proposed development.
- There are minimal morning shadow impacts to the Granville Street entertainment district by the proposed development at 155' height as the building sits in the shadow line of the existing Chateau Granville to its west.
- As indicated in the diagrams on this page, there are no substantial increase to the shadowing of Helmcken Street created by the height increase from 70' to 155'.

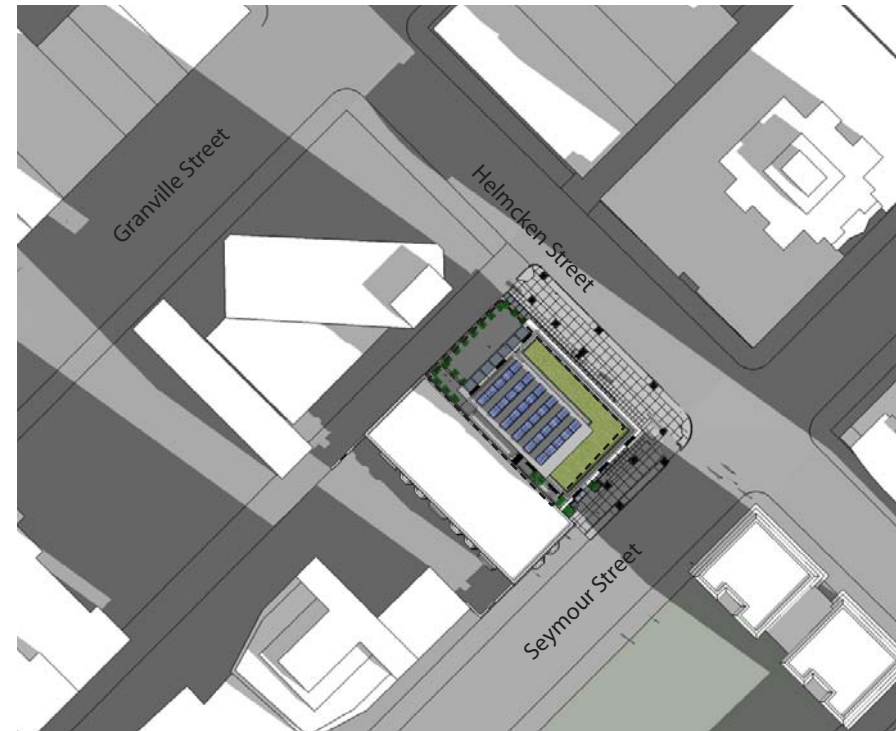

1) Equinox 9:00am PST

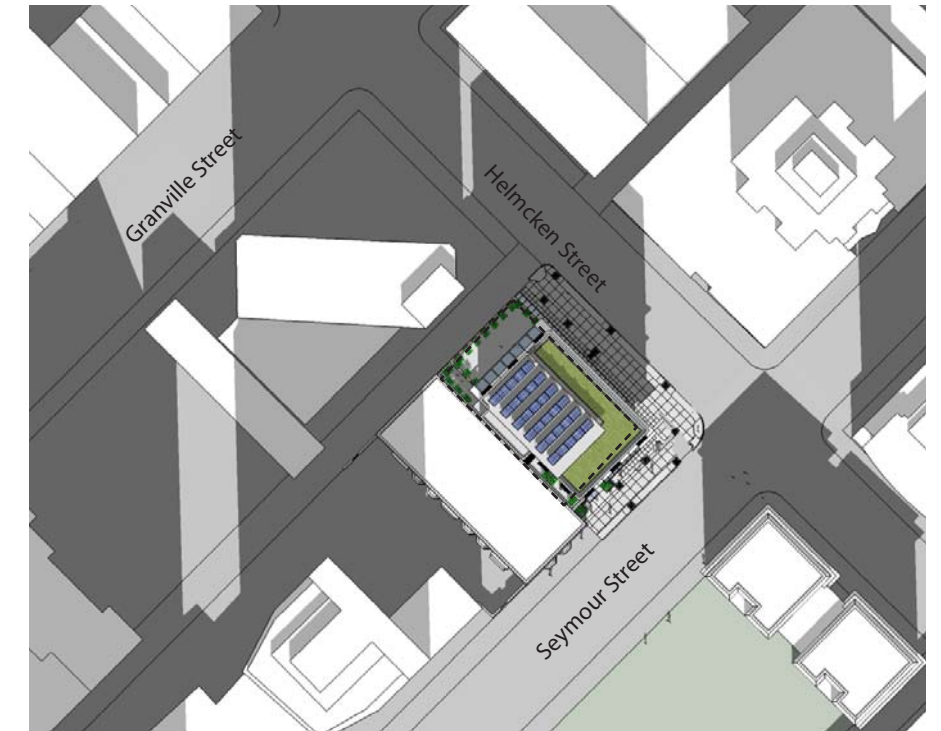

2) Equinox 12:00pm PST

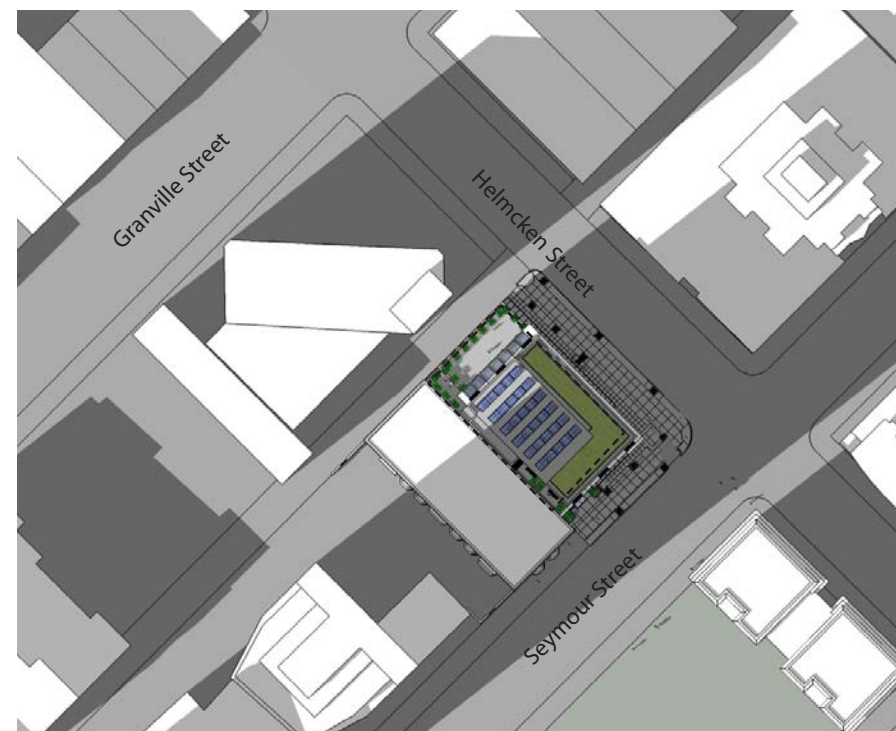

3) Equinox 3:00pm PST

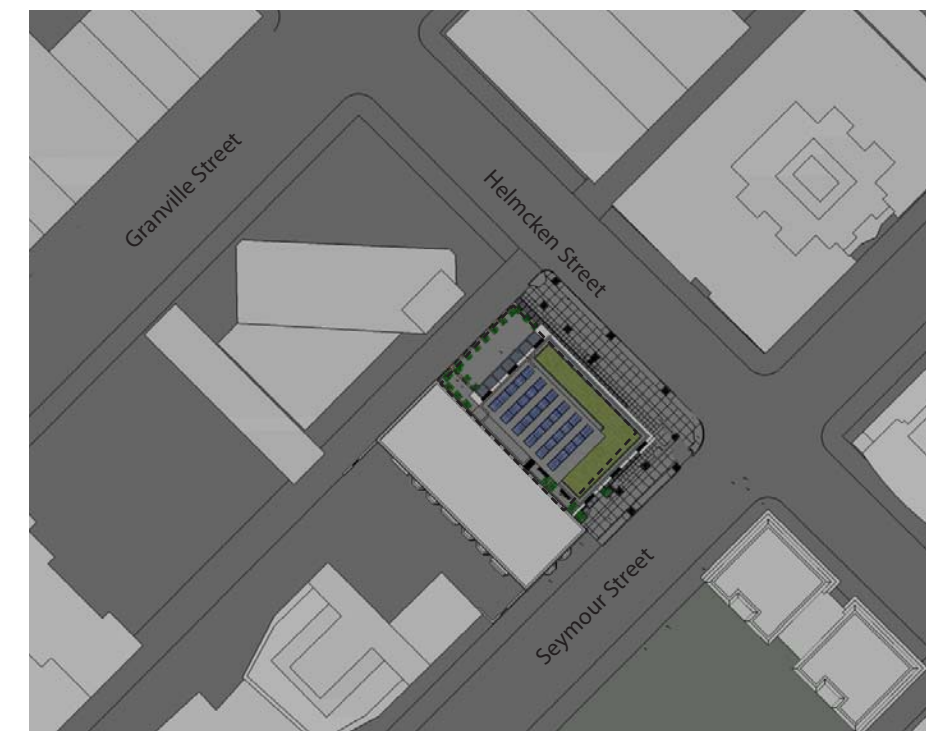

4) Equinox 6:00pm PST

