

2.13 View Studies

The three-dimensional model of the indicative design has been placed into photographs taken from prominent viewpoints at the edges of the site to show the proposed development within its context.

The view from Thornton Park at National Avenue shows how St. Paul's Plaza creates an open and welcoming gateway and transition from the park to the hospital entrance, while the buildings themselves frame and animate the plaza.

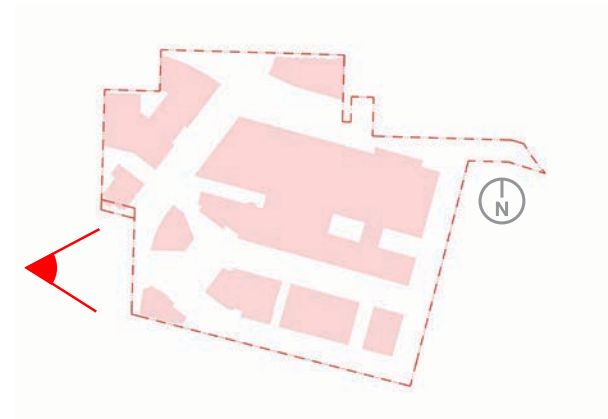

Figure 2-66: Thornton Park - Looking East



The view from Thornton Park looking north along Station Street shows how the southern office building frames north edge of the open space in front of Pacific Central Station and forms a strong gateway element for the hospital precinct.

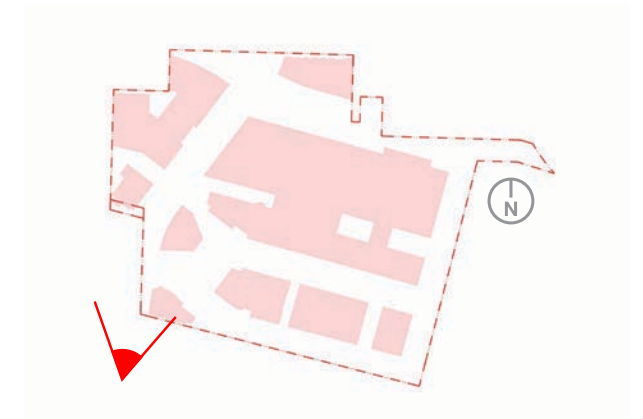

Figure 2-67: Thornton Park - Looking North



2.13 View Studies

The view from Atlantic Avenue looking southwest shows the modulated heights of the podium and towers and the stepping form of the towers in order to reduce shadowing on Trillium Park.

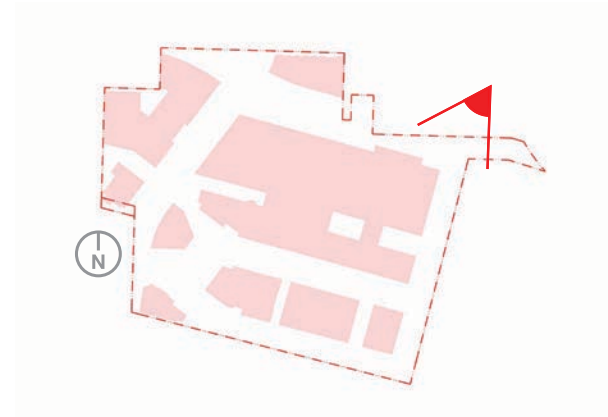

Figure 2-68: Atlantic Avenue - Looking West



The view from the north part of Trillium Park looking west shows the modulated heights of the podium and towers and the stepping form of the towers in order to reduce shadowing on the park.

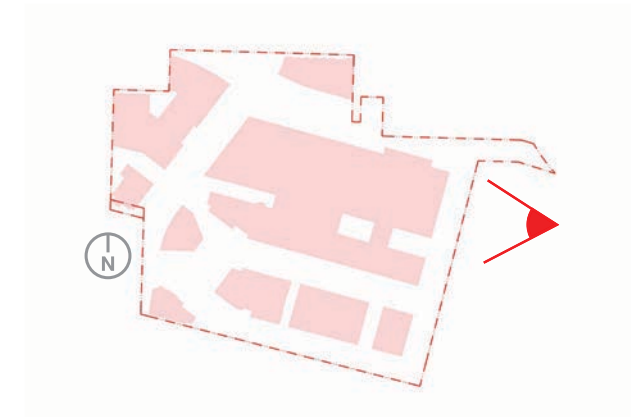

Figure 2-69: Trillium Park - Looking West

